



NATURE &
DECOUVERTES

LOCOMOTIVE - MAQUETTE À ASSEMBLER

LOCOMOTIVE - MODEL FOR ASSEMBLY
LOCOMOTORA - MAQUETA PARA MONTAR
LOCOMOTIEF - MODELSET
LOCOMOTIVA - MODELO PARA MONTAR

Réf. 42007310

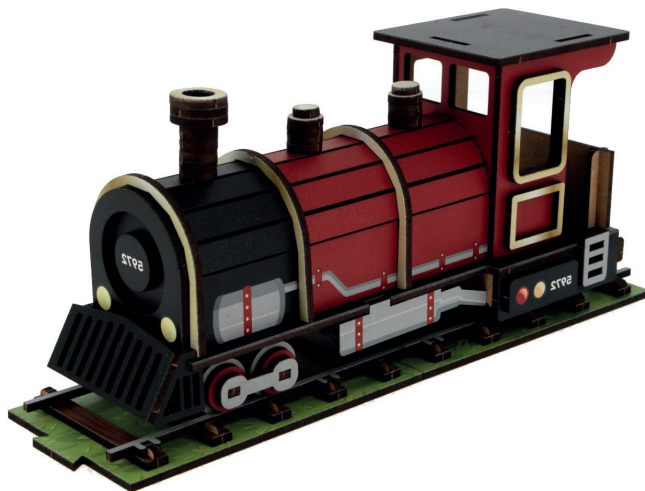

Lire attentivement et conserver soigneusement ce mode d'emploi.
Please carefully read this manual and keep it in a safe place.
Lea detenidamente este manual y consérvelo en un lugar seguro.
Lees deze instructies zorgvuldig en bewaar ze op een veilige plaats.
Leia cuidadosamente este manual e guarde-o em local seguro.

INSTRUCTIONS IMPORTANTES. À CONSERVER POUR USAGE ULTÉRIEUR : LIRE ATTENTIVEMENT

MESURES DE SÉCURITÉ

- Le jouet ne convient pas aux enfants de moins de 8 ans.
- La supervision d'un adulte est recommandée lors du montage du jouet.
- Notice a conserver pour usage ultérieur.

MONTAGE

- Détachez chacune des pièces et munissez-vous de colle liquide.
- Assemblez les pièces suivant l'ordre de montage, en ajoutant un point de colle à chaque étape, à l'exception des étapes 1 et 2 pour lesquelles la colle doit être mise uniquement aux emplacements repérés d'un point bleu afin d'assurer la bonne rotation des roues.

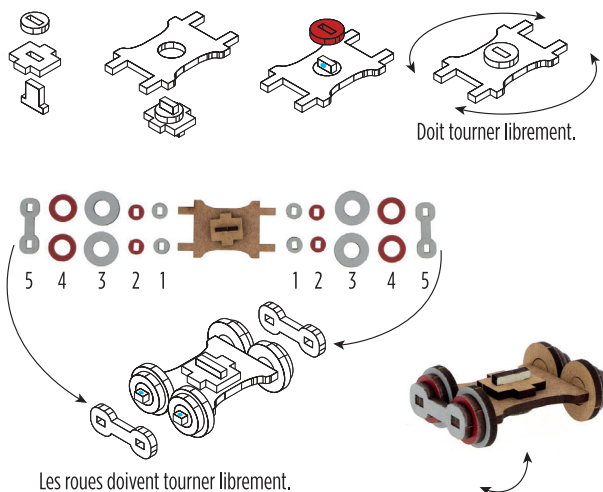
1

2

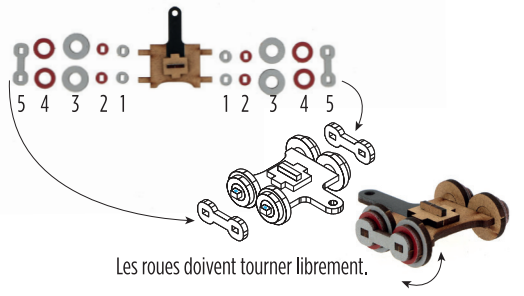
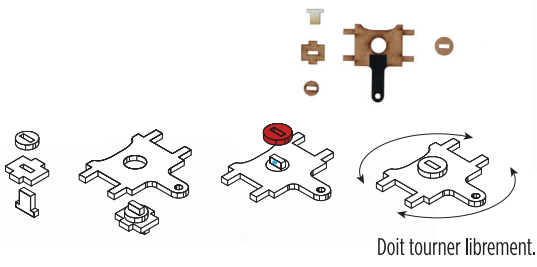

3

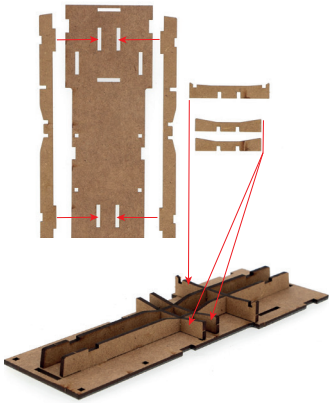

4

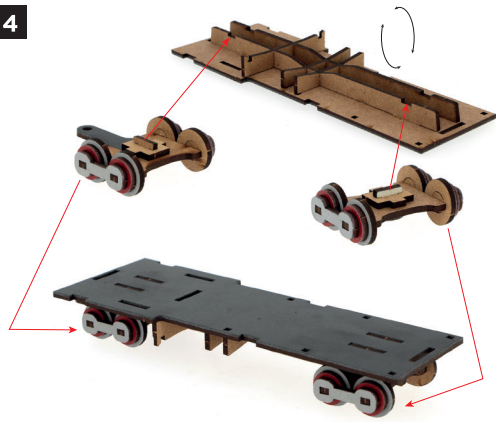

5

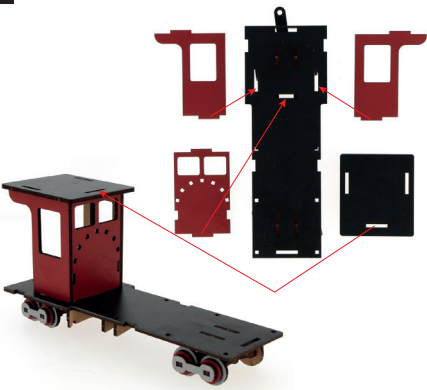

6



7



8

Faire de même pour le côté droit.

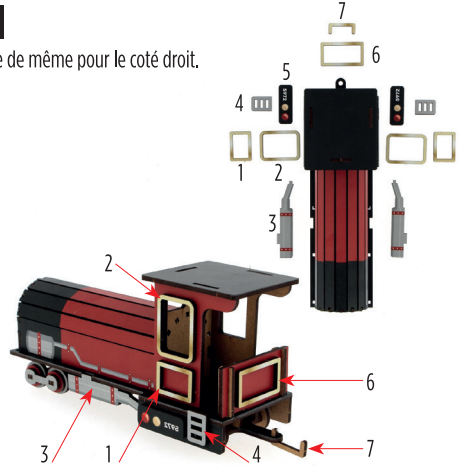

9

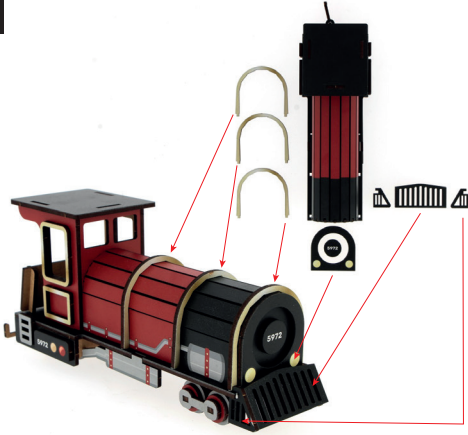

10

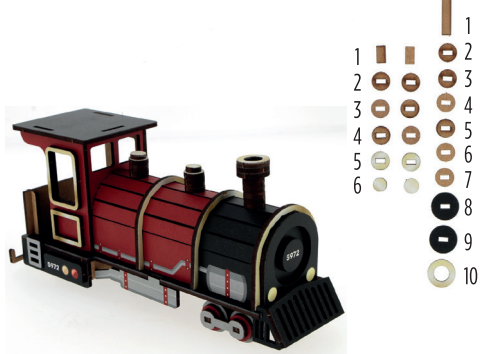

11

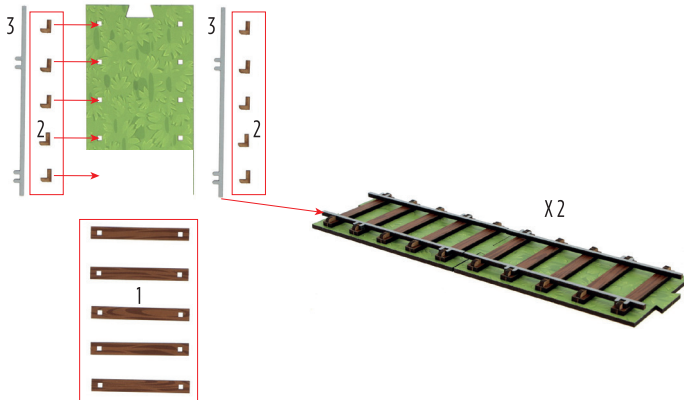

Et voilà !

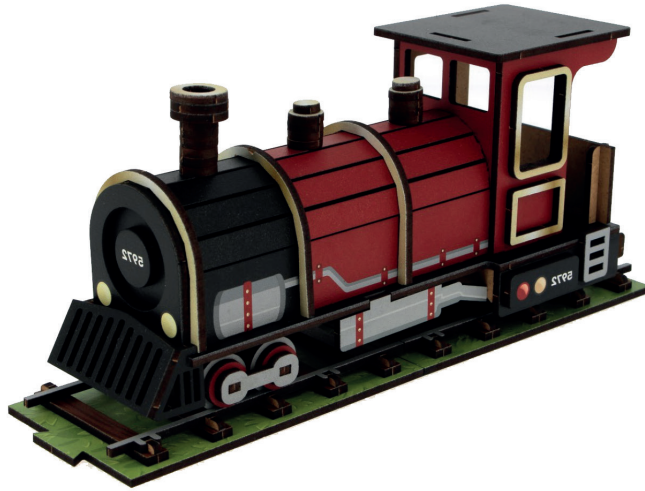

ENTRETIEN

Remarque : le non-respect de ces instructions peut endommager le jouet ou d'autres objets.

- Tenir le produit à l'écart de toute source de chaleur.
- Afin de ne pas endommager les composants, ne pas plonger le jouet dans l'eau.
- Nettoyer le produit avec un chiffon doux et sec.
- Ne pas utiliser de produit chimique comme du liquide nettoie-vitres, des aérosols, des solvants, de l'alcool, de l'ammoniaque ou des produits abrasifs, etc. pour nettoyer le jouet.

PLEASE CAREFULLY READ THIS MANUAL AND KEEP IT IN A SAFE PLACE

SAFETY MEASURES

- This toy is not suitable for children under 8 years of age.
- Adult supervision is recommended when assembling the toy.
- Keep the instructions for future reference.

ASSEMBLY

- Detach each of the pieces and apply liquid glue.
- Assemble the parts in the order in which they are to be fitted, adding a dot of glue at each stage, except for stages 1 and 2 where the glue should only be applied to the places marked with a blue dot to ensure that the wheels rotate correctly.

1

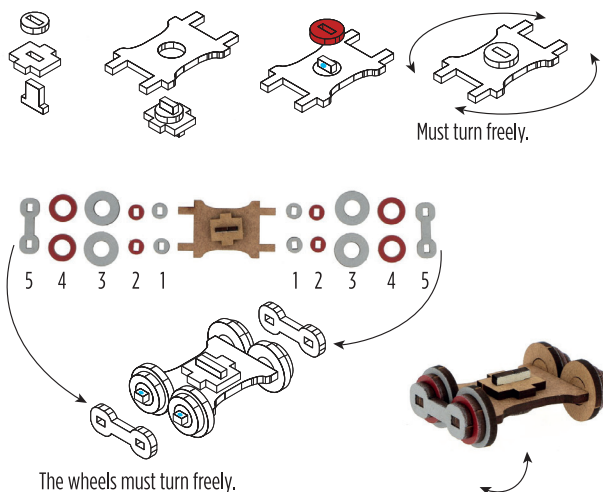

2

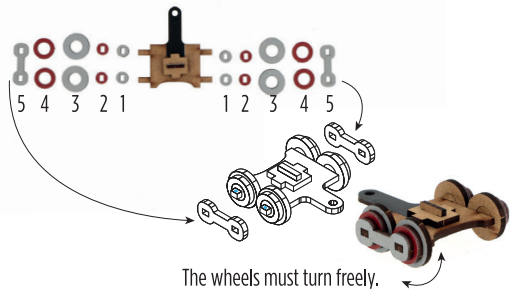
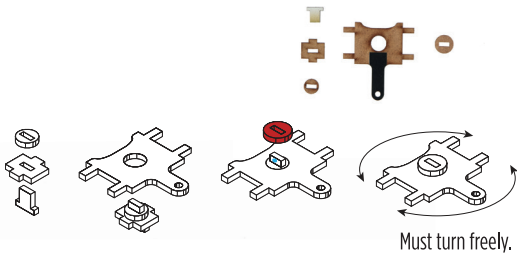

3

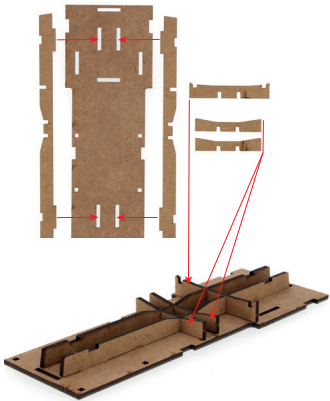

4

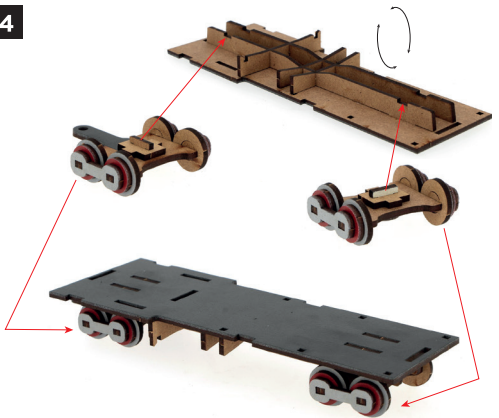

5

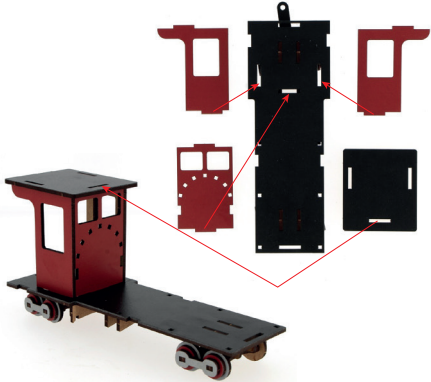

6



7



8

Do the same for the right-hand side.

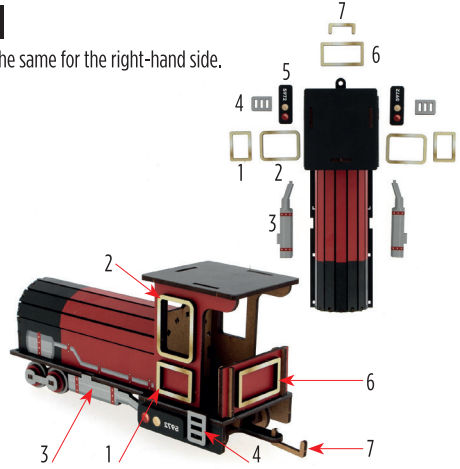

9

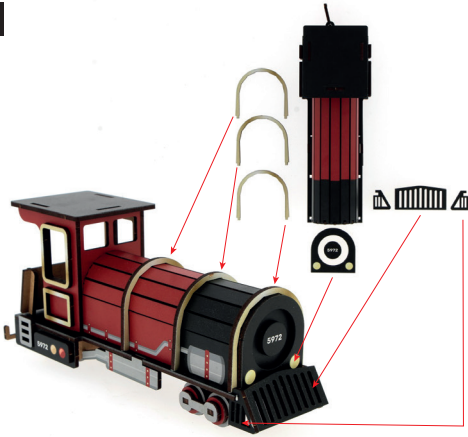

10

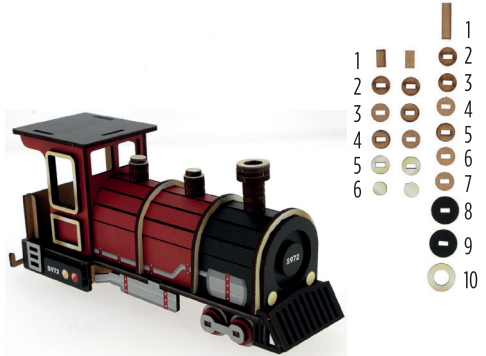

11

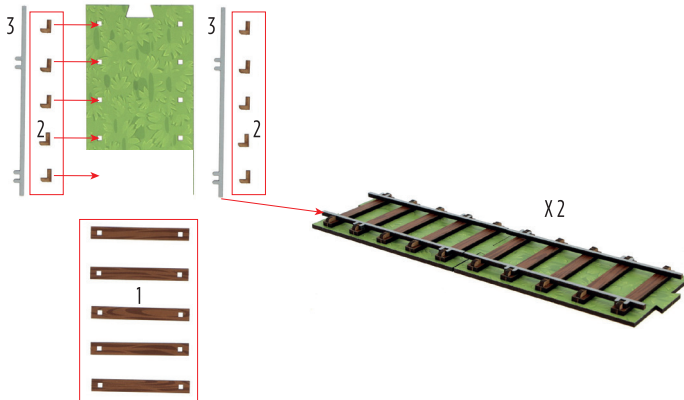

And there you have it!

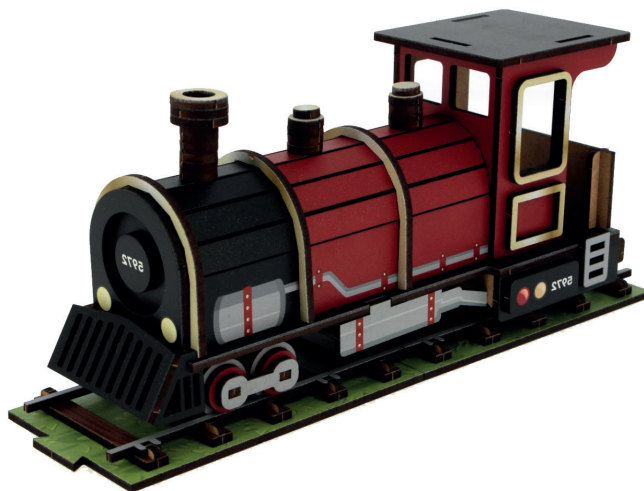

MAINTENANCE

Note: failure to follow these instructions may damage the toy or other objects.

- Keep away from sources of heat.
- To avoid damaging the components, do not immerse the toy in water.
- Clean the product with a soft, dry cloth.
- Do not use chemicals such as window cleaner, aerosols, solvents, alcohol, ammonia or abrasive products, etc. to clean the toy.

INSTRUCCIONES IMPORTANTES. MANTENGA PARA USO FUTURO: LEA CUIDADOSAMENTE

MEDIDAS DE SEGURIDAD

- Este juguete no es apto para niños menores de 8 años.
- Se recomienda la supervisión de un adulto al montar el juguete.
- Conservar este manual para uso futuro.

MONTAJE

- Separe cada una de las piezas y aplique pegamento líquido.
- Monte las piezas siguiendo el orden de montaje, añadiendo un punto de pegamento en cada paso, a excepción de los pasos 1 y 2 para los cuales el pegamento se debe poner únicamente en los lugares marcados con un punto azul para asegurar la buena rotación de las ruedas.

1

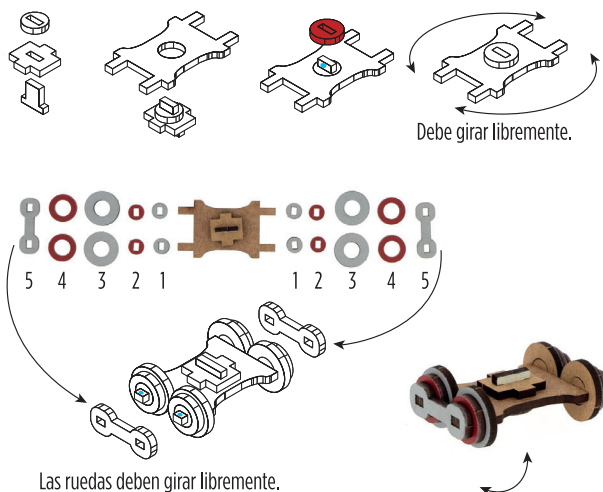

2

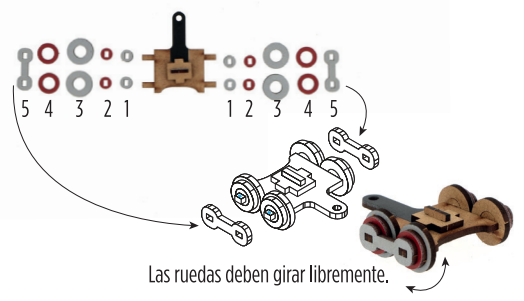
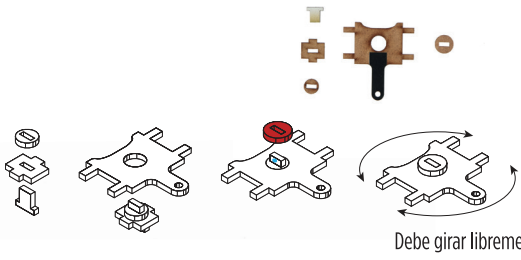

3

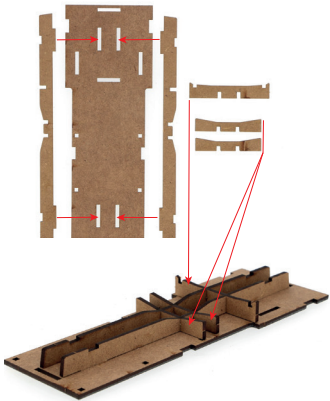

4

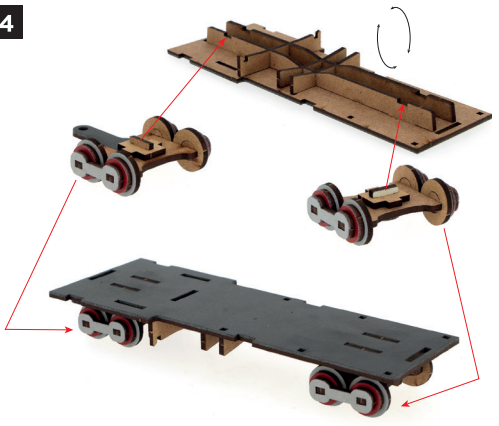

5

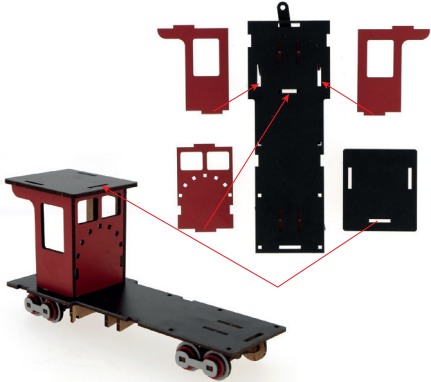

6



7



8

Haga lo mismo con el lado derecho.

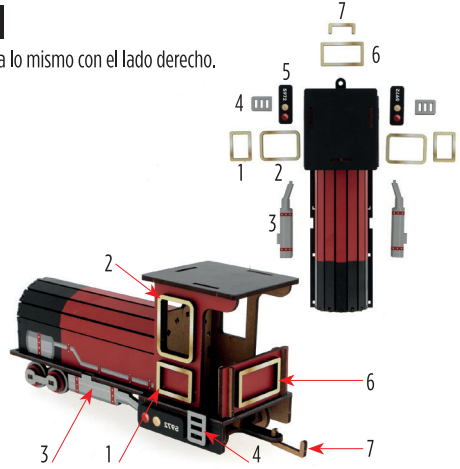

9

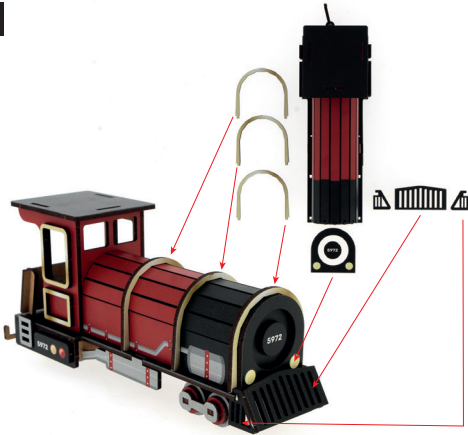

10

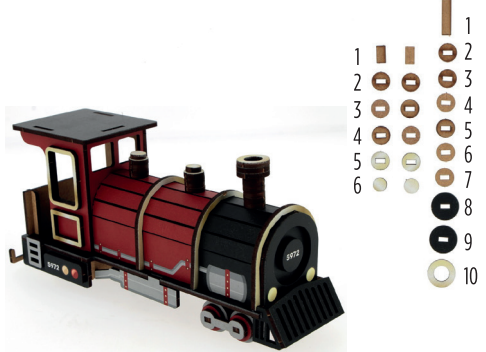

11

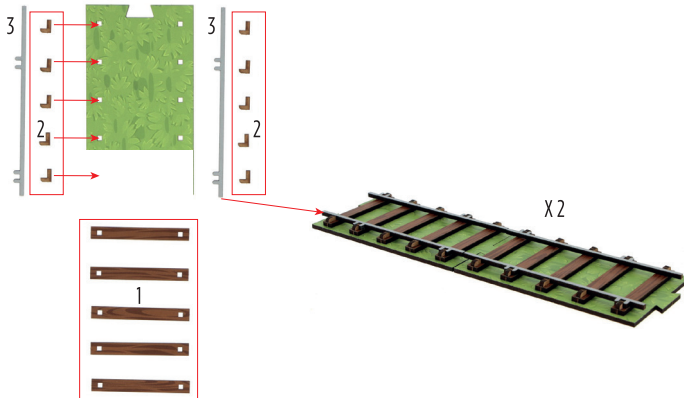

¡Y ahí lo tiene!

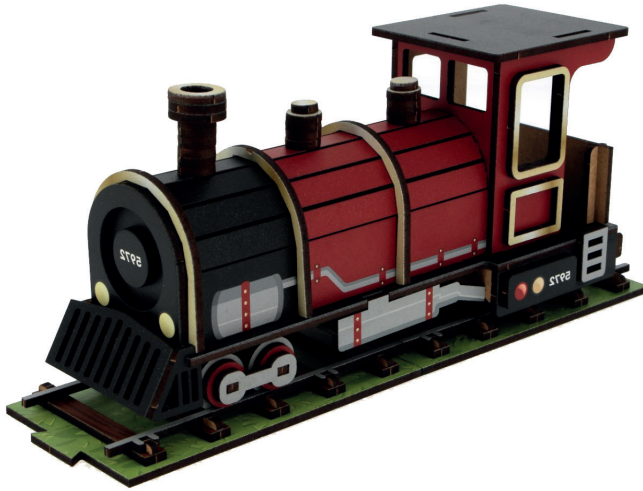

MANTENIMIENTO

Nota: no seguir estas instrucciones puede dañar el juguete u otros objetos.

- Mantenga el producto alejado de cualquier fuente de calor.
- Para evitar dañar los componentes, no sumerja el juguete en agua.
- Limpie el producto con un paño suave y seco.
- No utilice productos químicos como limpiacristales, aerosoles, disolventes, alcohol, amoníaco o productos abrasivos, etc. para limpiar el juguete.

BELANGRIJKE INSTRUCTIES. BEWAAR VOOR LATER GEBRUIK: LEES DE INSTRUCTIES AANDACHTIG

VEILIGHEIDSMATREGELEN

- Dit speelgoed is niet geschikt voor kinderen jonger dan 8 jaar.
- Toezicht door een volwassene wordt aanbevolen bij het in elkaar zetten van het speelgoed.
- De handleiding bewaren voor later gebruik.

MONTAGE

- Maak alle stukjes los en zorg ervoor dat je vloeibare lijm bij de hand hebt.
- Zet de onderdelen in elkaar in de juiste montagevolgorde en breng bij elke stap een beetje lijm aan, behalve bij stap 1 en 2 waar de lijm alleen moet worden aangebracht op de plaatsen die zijn aangeduid met een blauwe stip om ervoor te zorgen dat de wielen goed kunnen draaien.

1

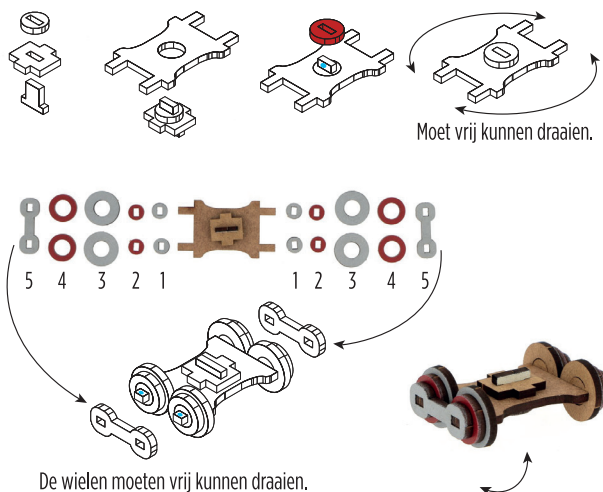

2

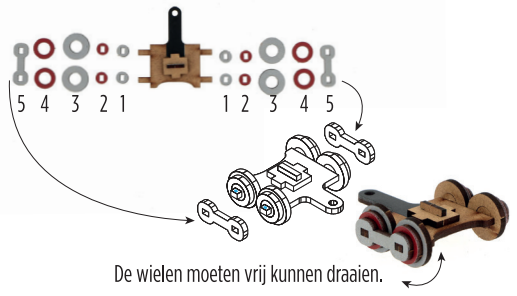
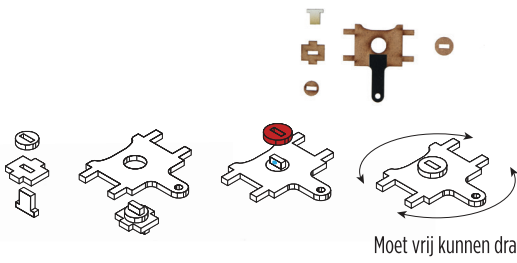

3

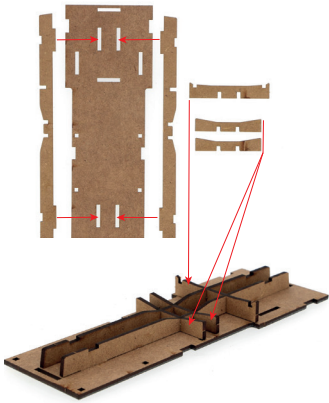

4

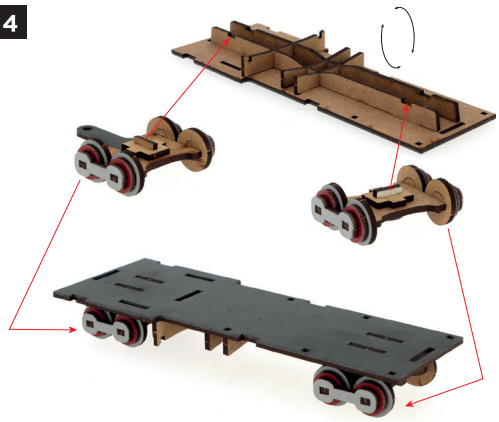

5

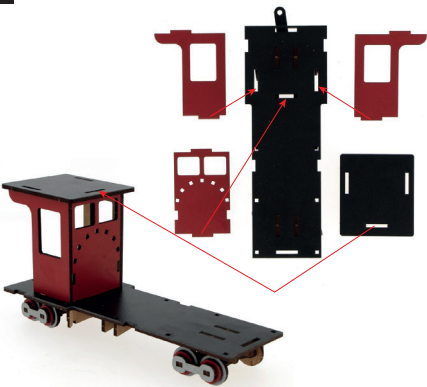

6



7



8

Doe hetzelfde voor de rechterkant.

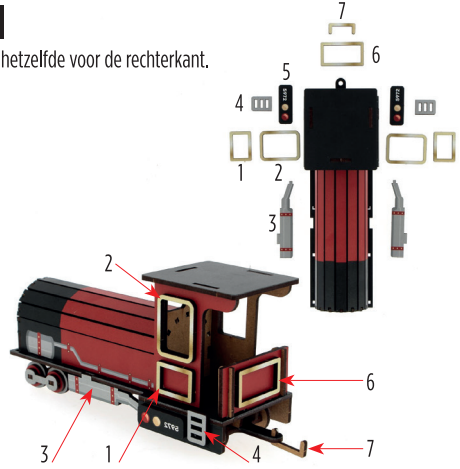

9

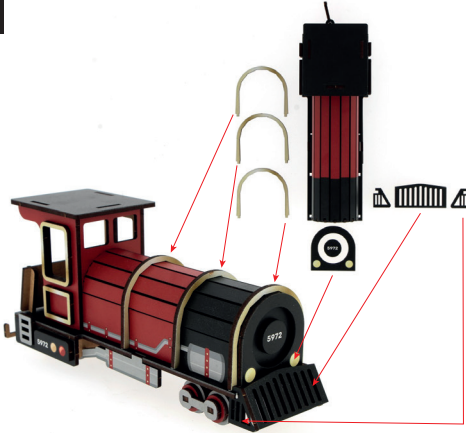

10

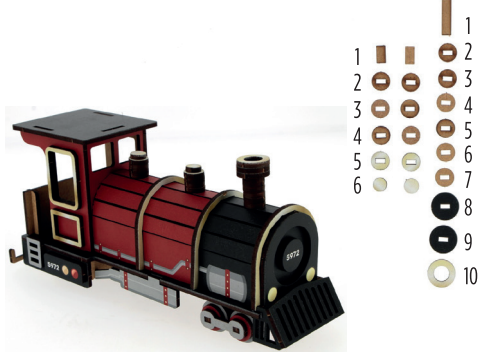

11

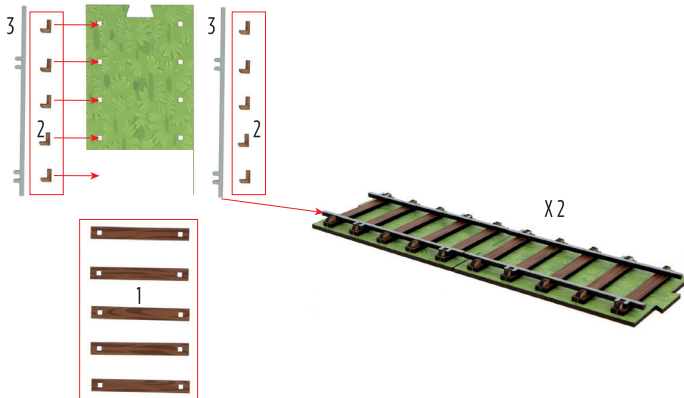

En klaar!

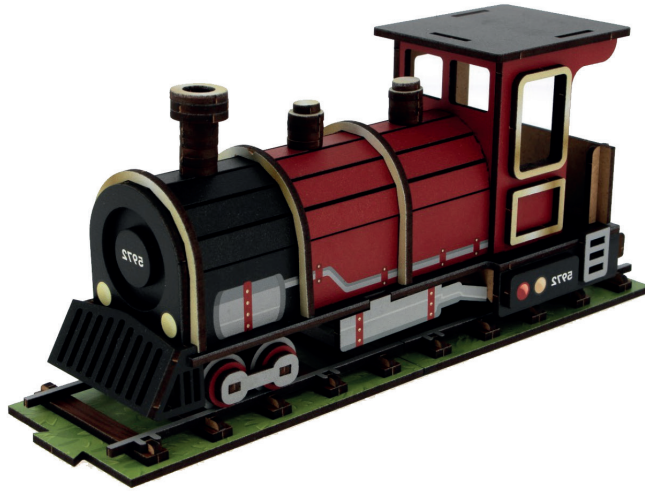

ONDERHOUD

Opmerking: als deze instructies niet opgevolgd worden, kunnen het speelgoed of andere voorwerpen beschadigd raken.

- Houd het product verwijderd van warmtebronnen.
- Dompel het speelgoed niet onder in water om beschadiging van de onderdelen te voorkomen.
- Reinig het product met een zachte, droge doek.
- Gebruik voor het schoonmaken van het speelgoed geen chemicaliën zoals ruitenreiniger, spuitbussen, oplosmiddelen, alcohol, ammoniak of schuurmiddelen.

INSTRUÇÕES IMPORTANTES. MANTENHA O USO FUTURO: LEIA CUIDADOSAMENTE

MEDIDAS DE SEGURANÇA

- O brinquedo está contra-indicado para crianças com menos de 8 anos.
- Recomenda-se a supervisão de um adulto durante a montagem do brinquedo.
- Guarde as instruções para utilização futura.

MONTAGEM

- Separe cada uma das peças e tenha consigo cola líquida.
- Monte as peças pela ordem de montagem, adicionando um ponto de cola em cada etapa, exceto nas etapas 1 e 2, nas quais a cola só deve ser aplicada nos locais marcados com um ponto azul, para garantir uma boa rotação das rodas.

1

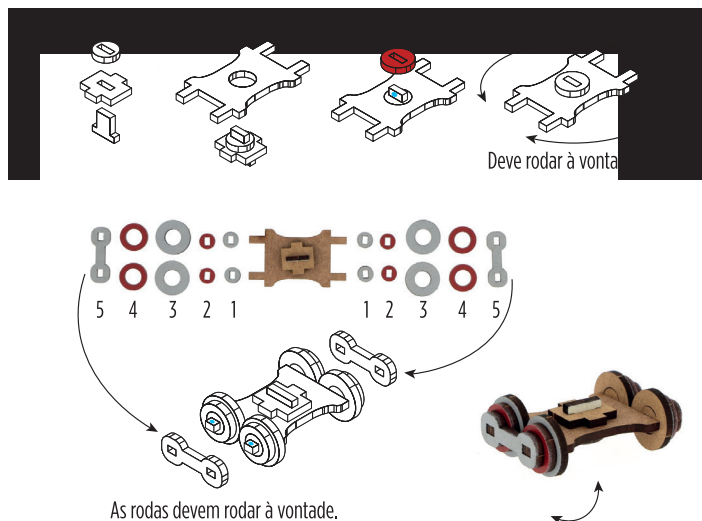

2

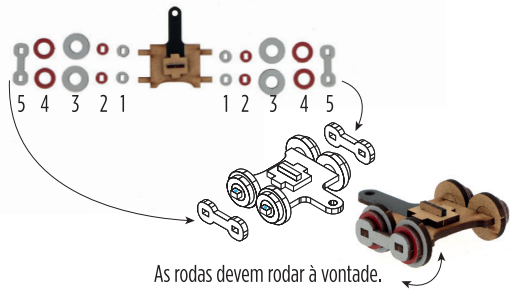
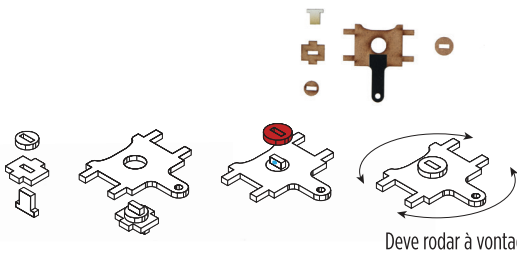

3

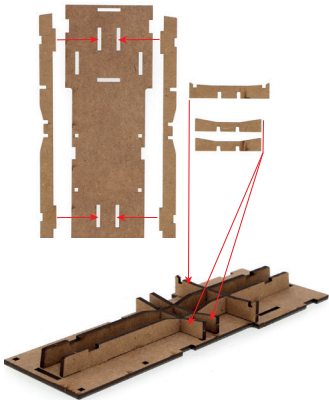

4

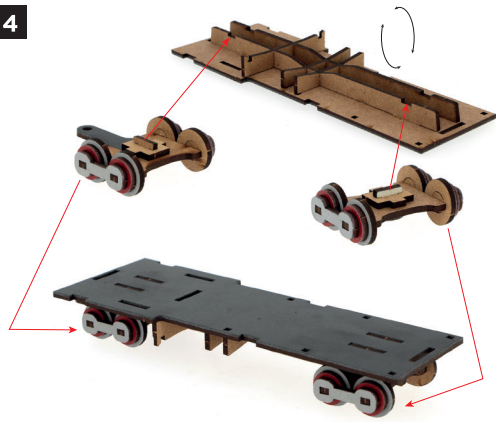

5

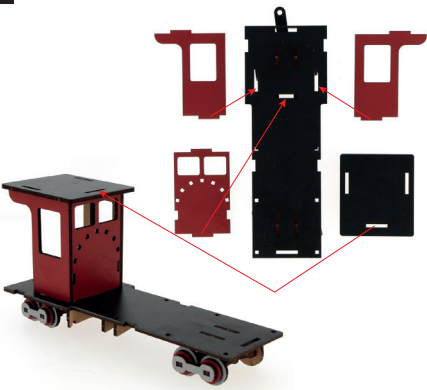

6



7



8

Repetir o processo no lado direito.

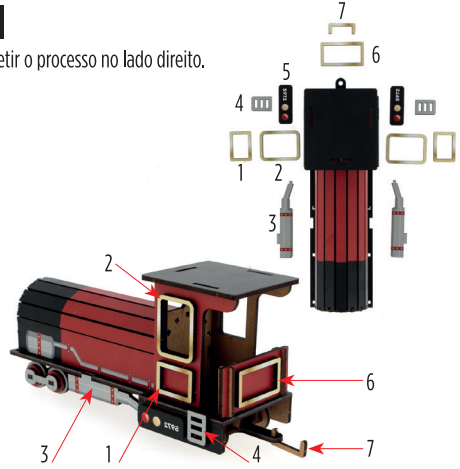

9

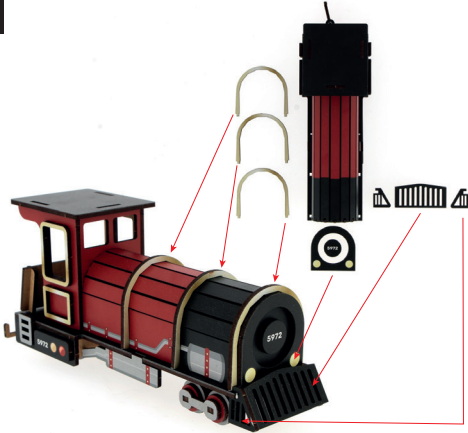

10

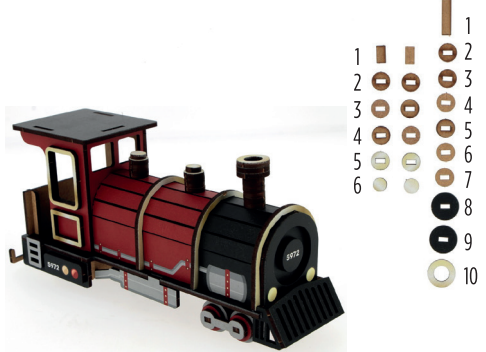

11

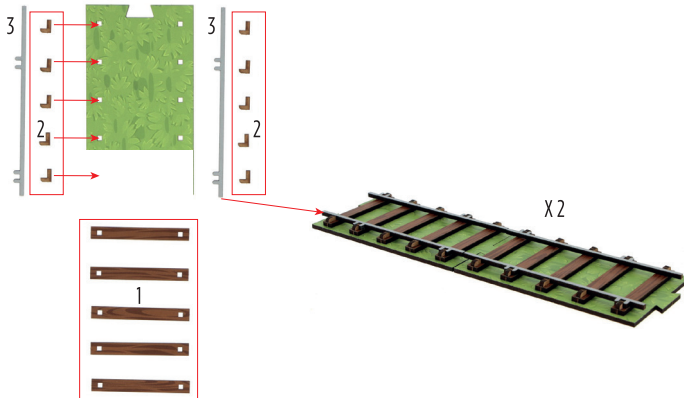

E já está!

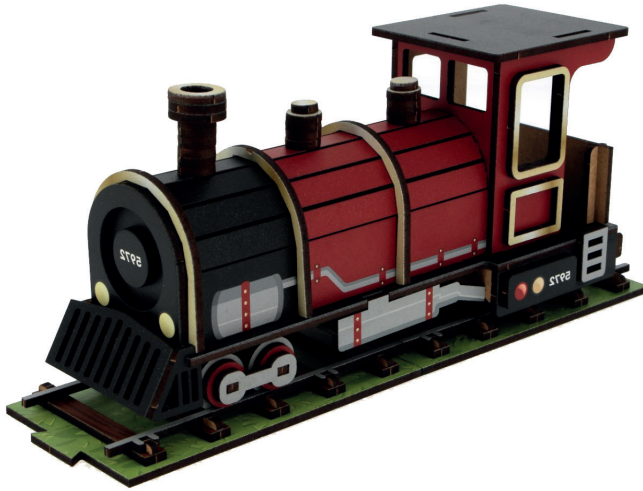

MANUTENÇÃO

Nota: o não cumprimento destas instruções pode danificar o brinquedo ou outros objetos.

- Manter o produto afastado de fontes de calor.
- Para evitar danificar os componentes, não mergulhar o brinquedo em água.
- Limpar o produto com um pano macio e seco.
- Não utilizar produtos químicos, tais como limpa-vidros, aerossóis, solventes, álcool, amoníaco ou produtos abrasivos, etc., para limpar o brinquedo.



Attention !

Ne convient pas aux enfants de moins de 36 mois. Danger d'étouffement.
Présence de petites pièces susceptibles d'être ingérées. Informations à conserver.

Warning!

Not suitable for children under 3 years of age. Choking hazard.
Contains small pieces that could be swallowed. xxx

¡Atención!

No apto para niños menores de 36 meses. Peligro de asfixia.
Presencia de piezas pequeñas que pueden ingerirse. xxxx

Opgelet!

Niet geschikt voor kinderen jonger dan 36 maanden. Risico op verstikking.
Bevat kleine onderdelen die ingeslikt kunnen worden. xxxxx

Atenção!

Contra-indicado para crianças com idade inferior a 36 meses.
Risco de asfixia. Composto por peças pequenas suscetíveis de serem ingeridas. xxxxxx

Nature & Découvertes
11 rue des Etangs Gobert
78000 Versailles (France)
www.natureetdecouvertes.com



Conforme aux normes européennes.
Compliant with European standards.
Conforme con las normas europeas.
In overeenstemming met Europese normen.
Em conformidade com as normas europeias.

